



# 4K HDMI<sup>®</sup> to 6G SDI Converter with SDI Loop Out

P/N 30445

## User's Manual

# SAFETY WARNINGS AND GUIDELINES

Please read this entire manual before using this device, paying extra attention to these safety warnings and guidelines. Please keep this manual in a safe place for future reference.

- This device is intended for indoor use only.
- Do not expose this device to water or moisture of any kind. Do not place drinks or other containers with moisture on or near the device. If moisture does get in or on the device, immediately unplug it from the power outlet and allow it to fully dry before reapplying power.
- Do not touch the device, the power cord, or any other connected cables with wet hands.
- Do not expose this device to excessively high temperatures. Do not place it in, on, or near heat sources, such as a fireplace, stove, radiator, etc. Do not leave it in direct sunlight.
- Prior to operation, check the unit and power cord for physical damage. Do not use if physical damage has occurred.
- Before plugging the unit into a power outlet, ensure that the outlet provides the same type and level of power required by the device.
- Unplug this device from the power source when not in use.
- Take care to prevent damage to the power cord. Do not allow it to become crimped, pinched, walked on, or become tangled with other cords. Ensure that the power cord does not present a tripping hazard.
- Never unplug the unit by pulling on the power cord. Always grasp the connector head or adapter body.
- Ensure that power is turned off and disconnected before making any electrical connections.
- Clean using a soft, dry cloth only. Do not use chemical cleaners, solvents, or detergents. For stubborn deposits, moisten the cloth with warm water.
- This device has no user serviceable parts. Do not attempt to open, service, or modify this device.

## INTRODUCTION

Thank you for purchasing this 4K HDMI® to 6G SDI Converter! This converter can accept 4K, 1080p, 1080i, 720p, and 480i HDMI® signals and outputs the corresponding SDI output without any signal loss. It includes a mirrored SDI output for a second display.

## FEATURES

- Automatically detects the HDMI input signal
- Compliant with the SMPTE ST-2081, SMPTE 425M-AB, SMPTE 424M, SMPTE 292M, and SMPTE 259M-C standards
- Supports 5.94Gbps, 5.94/1.001Gbps, 2.97Gbps, 2.97/1.001Gbps, 1.485Gbps, 1.485/1.001Gbps, and 270Mbps SDI bit rates
- Supports HDMI® resolutions up to 4K@30Hz
- Built-in SDI re-driver for long cable runs
- Includes an analog stereo audio input
- Firmware can be updated from an external USB flash drive (FAT32 file system only)

## CUSTOMER SERVICE

The Monoprice Customer Service department is dedicated to ensuring that your ordering, purchasing, and delivery experience is second to none. If you have any problem with your order, please give us an opportunity to make it right. You can contact a Monoprice Customer Service representative through the Live Chat link on our website [www.monoprice.com](http://www.monoprice.com) during normal business hours (Mon-Fri: 5am-7pm PT, Sat-Sun: 9am-6pm PT) or via email at [support@monoprice.com](mailto:support@monoprice.com)

# PACKAGE CONTENTS

Please take an inventory of the package contents to ensure you have all the items listed below. If anything is missing or damaged, please contact Monoprice Customer Service for a replacement.

- 1x HDMI® to 6G-SDI converter
- 1x AC power adapter (12 VDC, 1A)
- 1x User's manual

# PRODUCT OVERVIEW

## Front Panel

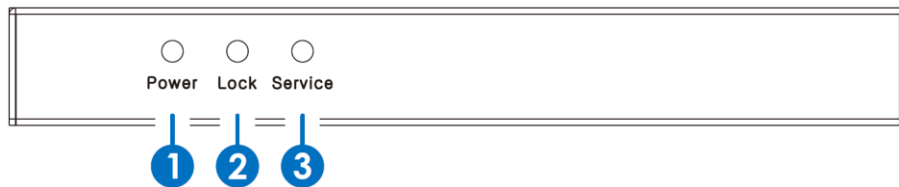

1. **Power:** The Power LED illuminates when power is applied.
2. **Lock:** The Lock LED illuminates when the input HDMI® signal is properly locked.
3. **Service:** The Service LED illuminates while the firmware is being updated.

## Rear Panel

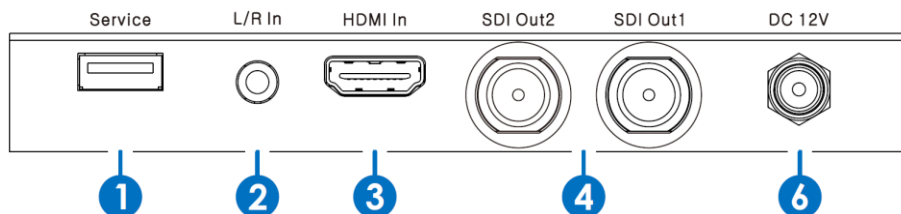

1. **Service:** USB port for connecting a USB flash drive to update the firmware (FAT32 file system only).

2. **L/R In:** 3.5mm analog stereo audio input jack.
3. **HDMI In:** HDMI® input port for connecting the video source device.
4. **SDI Out 2:** BNC connector for connecting an SDI display.
5. **SDI Out 1:** BNC connector for connecting an SDI display.
6. **DC 12V:** DC barrel connector for connecting the included AC power adapter.

## SAMPLE CONNECTION DIAGRAM

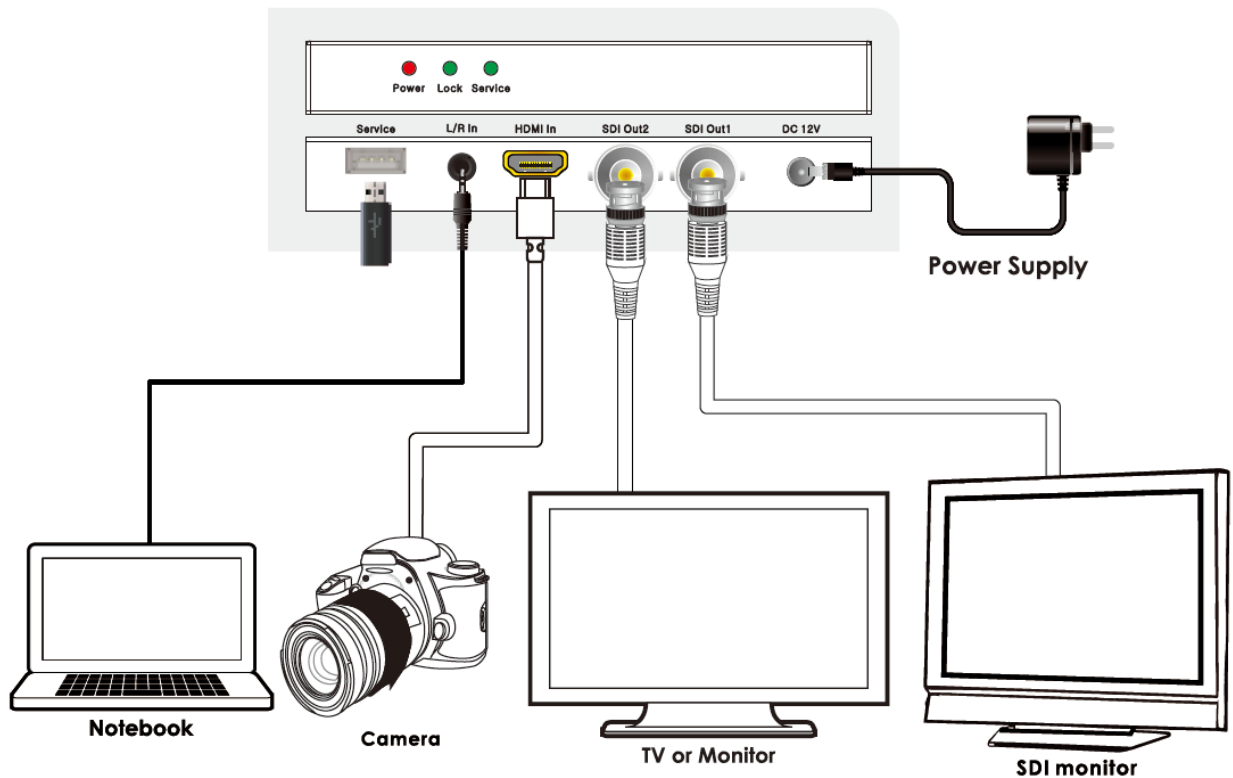

## CONNECTION

1. Ensure that all equipment to be connected is powered off and unplugged from its power source.
2. Place or mount the converter in its intended location.
3. Using an SDI cable (not included), plug one end into the SDI input on your display, then plug the other end into the **SDI Out 1** port on the converter.
4. (Optional) Using an SDI cable (not included), plug one end into the SDI input on a second display, then plug the other end into the **SDI Out 2** port on the converter.
5. Using a High Speed HDMI® Cable (not included), plug one end into the **HDMI In** port on the converter, then plug the other end into the HDMI output on your video source device.
6. (Optional) Using a 3.5mm stereo audio cable, plug one end into the **L/R In** jack on the converter, then plug the other end into the audio output on your audio source device.
7. Plug the barrel connector on the included AC power adapter into the **DC 12V** jack on the converter, then plug the adapter into a nearby AC power adapter.
8. Plug in and power on all connected equipment. Start video playback on your video source device, then verify that the video can be seen on the connected display(s).

*Congratulations, your SDI to HDMI converter is properly connected and ready for use!*

## TECHNICAL SUPPORT

Monoprice is pleased to provide free, live, online technical support to assist you with any questions you may have about installation, setup, troubleshooting, or product recommendations. If you ever need assistance with your new product, please come online to talk to one of our friendly and knowledgeable Tech Support Associates. Technical support is available through the online chat button on our website [www.monoprice.com](http://www.monoprice.com) during regular business hours, 7 days a week. You can also get assistance through email by sending a message to [tech@monoprice.com](mailto:tech@monoprice.com)

## SPECIFICATIONS

Model	30445
Inputs	1x HDMI®, 1x 3.5mm TRS
Outputs	2x SDI (BNC)
Supported SMPTE Standards	ST-2081, 425M-AB, 424M, 292M, 259M-C
Supported SDI Formats	525/29.97 NTSC, 625/25 PAL 720p50, 720p59.94, 720p60, 1080i50, 1080i59.94, 1080i60, 1080p23.98, 1080p24, 1080p25, 1080p29.97, 1080p30, 1080p50, 1080p59.94, 1080p60 3840x2160p23.98, 3840x2160p24, 3840x2160p25, 3840x2160p29.97, 3840x2160p30, 3840x2160p24
Video Bandwidth	5.94Gbps, 5.94/1.001Gbps, 2.97Gbps, 2.97/1.001Gbps, 1.485Gbps, 1.485/1.001Gbps, 270Mbps
Color Space	YCbCr 4:2:2
Color Depth	10-bits
Audio Formats	PCM 2CH with 48kHz sample rate
Input Power	12 VDC, 1A
AC Adapter Input Power	100 ~ 240 VAC, 50/60 Hz
Maximum Power Consumption	3.6 watts
Operating Temperature	+32 ~ +104°F (0 ~ +40°C)
Storage Temperature	-4 ~ +140°F (-20 ~ +60°C)
Operating Humidity	20 ~ 90% RH, non-condensing
Dimensions	5.4" x 3.3" x 0.7" (138 x 84 x 18 mm)
Weight	10.8 oz. (305 g)

*HDMI, the HDMI Logo, and High-Definition Multimedia Interface are trademarks or registered trademarks of HDMI Licensing LLC in the United States and other countries.*